

Unless otherwise specified, all coning on this layout is Detail C1

KEY

- Traffic sign
- Traffic cone

DETAIL A (A)

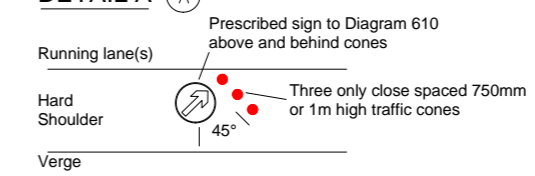

- Notes:
- 1) During darkness, a single warning light to BS EN 12352:2006 should be provided in accordance with Table A1.3 (Appendix 1).
 - 2) Traffic cones should conform to diagram 7101.1 and to BS EN 13422.

DETAIL B (B)

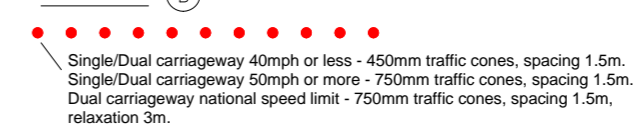

- Notes:
- 1) During darkness, warning lights to BS EN 12352:2006 should be provided in accordance with Table A1.3 (Appendix 1).
 - 2) 45° tapers have 1.5m spacing, no relaxations.
 - 3) On motorways and NSL AP duals with hard shoulders, 1m cones will be required for both standard and relaxation works for lead tapers and the facing wall of lane changes.

DETAIL C1 (C1)

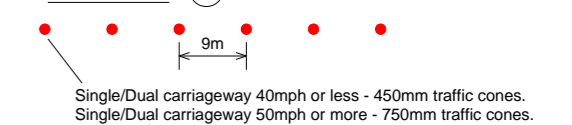

- Notes:
- 1) During darkness, warning lights to BS EN 12352:2006 should be provided in accordance with Table A1.3 (Appendix 1).
 - 2) For relaxation to Detail C1 see Table A1.3 (Appendix 1).

DETAIL C2 (C2)

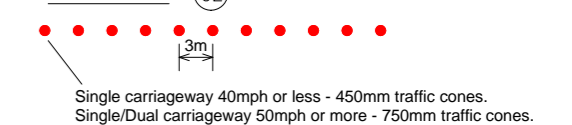

- Notes:
- 1) During darkness, warning lights to BS EN 12352:2006 should be provided in accordance with Table A1.3.

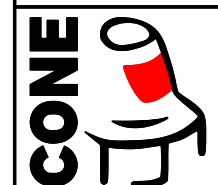

CADaptor Solutions
www.conesoftware.com
+44 (0) 1484 489339

TEMPORARY
TRAFFIC MANAGEMENT
TYPICAL LAYOUTS

1	JAN 2013
Issue	Date

OVER-NIGHT WORKS TO NEARSIDE
VERGE OF MULTI-LEG ROUNDABOUT
M1 - JUNCTION 34

Drawing No

CONE-XXXXX

Original drawing size A2- NTS