

CLOSURE OF RIGHT HAND LANE ON WESTERN APPROACH

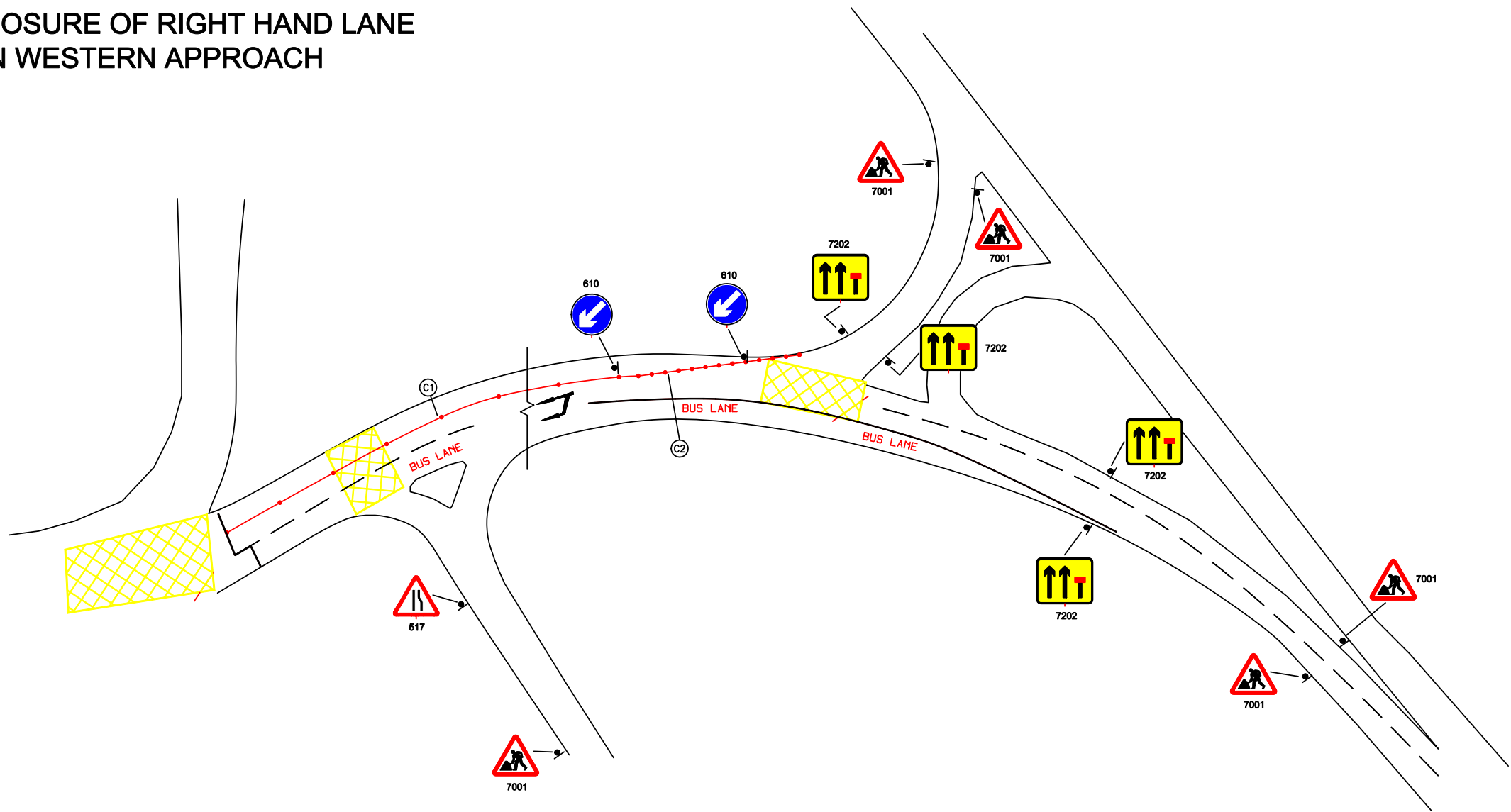

KEY

-  Traffic sign
-  Traffic cone

DETAIL C1 (C1)

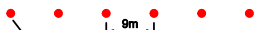

Single/Dual carriageway 40mph or less - 450mm traffic cones.
Single/Dual carriageway 50mph or more - 750mm traffic cones.

Notes:

- 1) During darkness, warning lights to BS EN 12352:2006 should be provided in accordance with Table A1.3 (Appendix 1).
- 2) For relaxation to Detail C1 see Table A1.3 (Appendix 1).

DETAIL C2 (C2)



Single carriageway 40mph or less - 450mm traffic cones.
Single/Dual carriageway 50mph or more - 750mm traffic cones.

Notes:

- 1) During darkness, warning lights to BS EN 12352:2006 should be provided in accordance with Table A1.3.

Night Time Works
From 21st September
until 26th November

Westcountry Road Management Ltd
Unit 1, Blacksmith Lane, Wrangaton,
Nr South Brent, Devon. TQ10 9HF
Tel: 01364 73477

Exe Bridge
South Parapet
Replacement

Issue	Date

Traffic Management Plan
Upstream
Night Time

Drawing No

EXE PHASE 2 - SHEET 2 OF 2

Original drawing size A3